

Option

Grass box



LED head light



Sun shade



Protective net



Front scraper

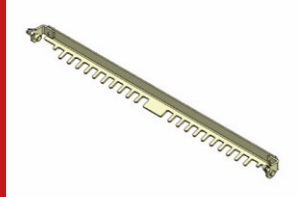

Rear scraper



Rear roller brush



Side plates kit



LM351

SURROUND & TRIM MOWER

Specifications

Model		LM351	
Mower unit type	#1	76.2 cm	30 in
	#2, #3	66.0 cm	26 in
Dimensions	Total length	Front roller type	290 cm / 114.17 in
		Caster wheel type*	298 cm / 117.32 in
	Total width	During operation	208 cm / 81.89 in
		During transport	187 cm / 73.62 in
Total height	ROPS	204 cm / 80.31 in	
	Steering wheel	129 cm / 50.79 in	
Weight	Machine (empty fuel tank)	1065kg / 2347.92lb	1084 kg / 2399.81 lb
	Grass boxes (for one machine)	17 kg	37.48 lb
Minimum turning radius		494 cm	194.5 in
Engine	Model	Kubota D1105-E4B	
	Type	Vertical water-cooled 4-cycle diesel engine	
	Total displacement	1,123 cm ³ (1,123 L)	68.52 cu.in.
	Rated output	18.5 kW (25.2 PS)/3,000 rpm	
Fuel tank capacity		Diesel 38.0 dm ³ (38.0 L)	Diesel 10.04 U.S.gals
Operating width (mowing width)		184 cm	72.44 in
Operating height	Front roller	10.0 - 46.0 mm	0.39 - 1.81 in
	Caster wheel*	20.0 - 50.0 mm	0.79 - 1.97 in
Number of blades		5, 7	
Drive	Traveling	Forward : 4WD	Reverse : 2WD
	Mowing	Hydraulic	
Speed (HST)	Forward	0 - 15.5 km/h	0 - 9.63 mph
	Reverse	0 - 8.0 km/h	0 - 4.97 mph
Efficiency		14,720 m ² /h (10.0 km/h x mowing width x 0.8)	3.60 acres/hour (6.21 mph x mowing width x 0.8)
Maximum inclination for operation		20 degrees	
Tire size	Front wheel	23 x 10.50 - 12	
	Rear wheel	18 x 8.50 - 10	

For optional specifications *



Great for mowing tees and edges of greens and bunkers

A multipurpose riding mower with superb climbing power and compact turning



Climbing performance

The LM351 has 4WD, designed with a low center of gravity that makes climbing hills easy. The cross hydraulic circuit keeps the mower from slipping on the slope.



Turning performance

Its smallest turning radius (measured from the inner wheels) is 33.19 inches. This 4-wheel mower's compact turning performance is superb. It excels in cutting around trees and along the edge lines of bunkers.

Cross hydraulic circuit

The cross circuit evenly distributes hydraulic power to all 4 wheels. This enables all tires to hold steady power on a slope and allows the mower to operate smoothly.

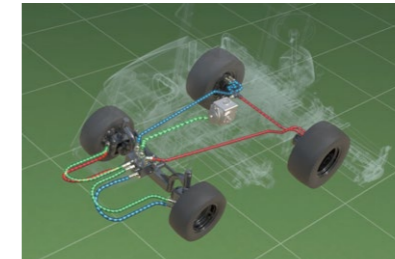

Centralized control panel

All the levers are centralized on a control panel for a comfortable operational environment.



USB ports

The LM351 is equipped with two USB ports for charging devices like mobile phones.



Easy maintenance

The bonnet can be fully opened without a tool. That means less hassle for maintenance work.



Baroness reel cutter

Baroness's high-quality long-lasting reel cutter was created by Baroness's proprietary steel preparation and manufacturing method. Its cutting quality stays the same through all 18 holes. It has earned the trust of greenskeepers around the world.

